

**Roto Patio Inowa:**  
**Intelligent hardware for tightly sealed  
sliding systems**

Greater  
convenience  
with  
SoftClose





## The space is yours

**Requirements for living spaces, particularly those located in urban environments, mean that buildings are becoming increasingly taller. The Roto Patio Inowa sliding system provides forward-thinking solutions for the architectural challenges that have arisen as a result.**

The tightly sealed locking mechanism protects against heavy driving rain and increasing wind pressure on upper floors. Even noise from the street and the environment are virtually completely quietened. The locking even prevents break-in attempts in accordance with resistance class RC 2 and decreases the energy consumption. Thanks to the innovative closing movement perpendicular to the frame profile and the specially developed Soft functions, the space-saving sliding windows and doors slide smartly and are particularly easy to operate. The compact and concealed technology also allows for narrow profiles with a modern design. Whether a small kitchen window or extensive glass facades in office buildings – Roto Patio Inowa allows a lot of light into the room, but not a lot else.



## **Roto Patio Inowa**

---

**Modern design,  
maximum comfort,  
efficient to  
work with**

# Roto Patio Inowa

Smart sliding

Shift your  
sights to  
comfort

Roto Patio Inowa stands for smart sliding. The innovative closing movement perpendicular to the frame profile means it is not necessary to lift the sash. As the structure is entirely mounted on rollers, it can be opened easily, quietly, comfortably and without any major effort, and can be moved in next to no time with the proven Roto handle design.

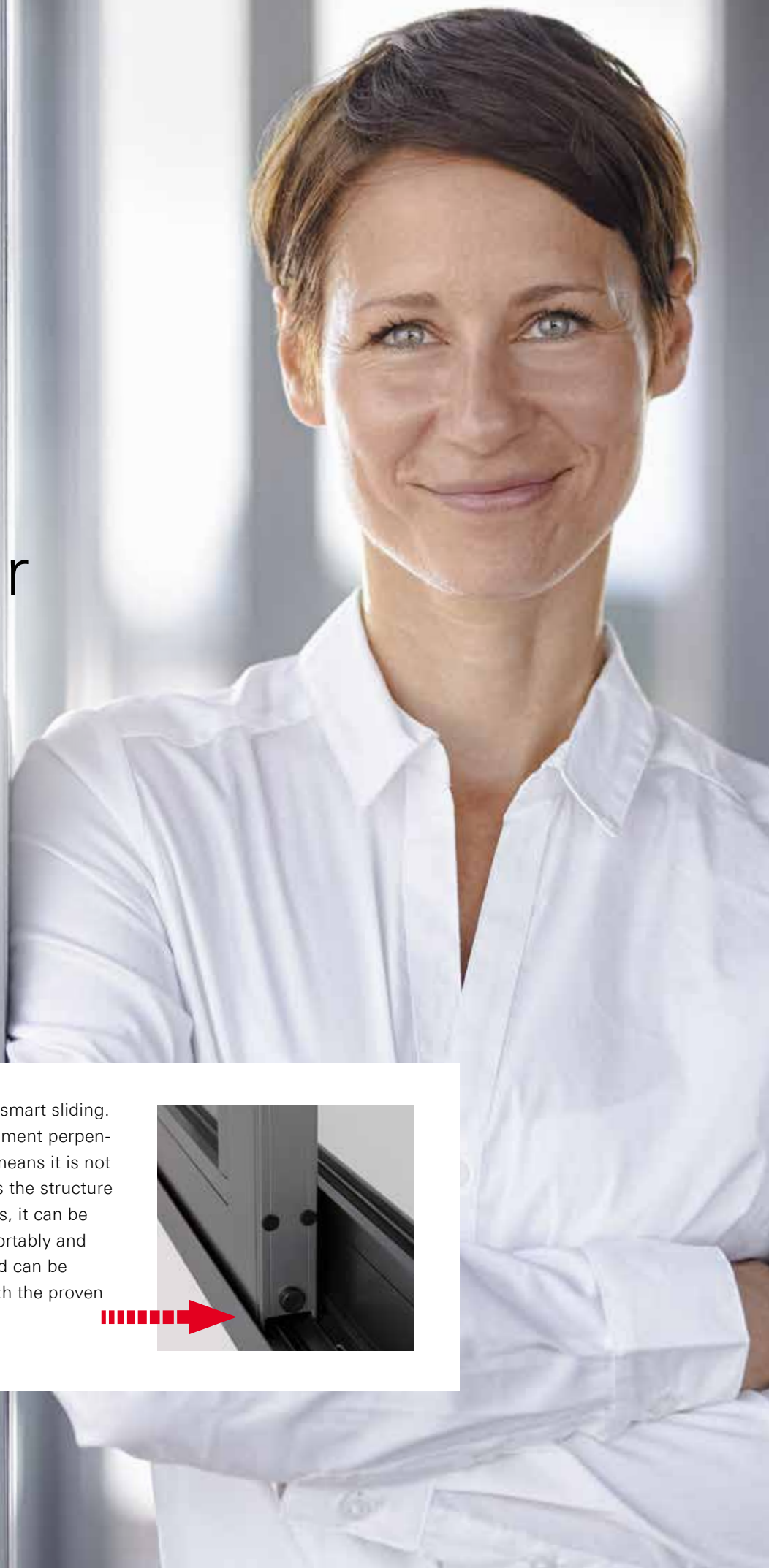

## The new Soft functions – making even heavy sashes float

The Soft functions of Roto Patio Inowa allow gentle opening and closing, and therefore a new level of comfort. There is no risk of incorrect operation, thanks to the secure braking. High-quality materials ensure a smooth running movement and minimise the noise level. Desired side-effect – the material is protected and the entire system remains particularly durable and low-maintenance.



| The **SoftClose function** gently brakes the sash when closing and moves it to the end position.

| The **SoftOpen function** briefly brakes the sash after opening and pulls it into the open final position.

| The **SoftStop function** helps with gentle closing or opening of the sash by braking it. This is used for timber-aluminium profiles from a weight of 200 kg.



## Roto Patio Inowa

Tightly sealed

# Tightly sealed – keeps not only the weather out

Roto Patio Inowa is setting new standards in sealing – no draughts can be felt, even in bad weather conditions with heavy rain and strong wind loads. The innovative closing movement perpendicular to the frame profile makes it unnecessary to lift the sash, allowing a circumferential gasket to be used. Together with the active control of all locking points, the whole element is tightly sealed. This hardware is therefore ideal for high-rise buildings subject to intense weather conditions.

The tightly sealed system reliably protects against noise in environments with high noise levels caused by traffic and construction sites. The hardware also prevents break-in attempts in accordance with RC 2, meaning that nothing stands between you and your peace of mind.



Driving rain impermeability  
up to class 9A

Air permeability  
up to class 4

# A carefully considered system – as varied as the requirements of our customers



## | Window handles

Modern window handles give living spaces a harmonious design. They can be locked with minimal effort, with or without a key. Thanks to the wide selection of colours, design concepts can be implemented down to the last detail.



## | Profile material

Roto Patio Inowa meets every material demand; the system can be easily installed in aluminium, timber-aluminium, timber and PVC elements.

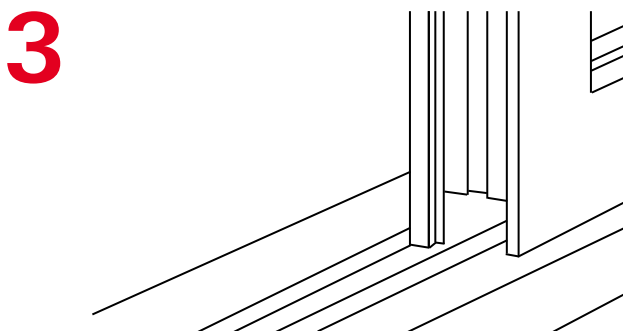

## | Enhanced threshold

A low threshold for timber and timber-aluminium allows for accessible transitions (according to DIN 18040) and an open, well-lit living concept.

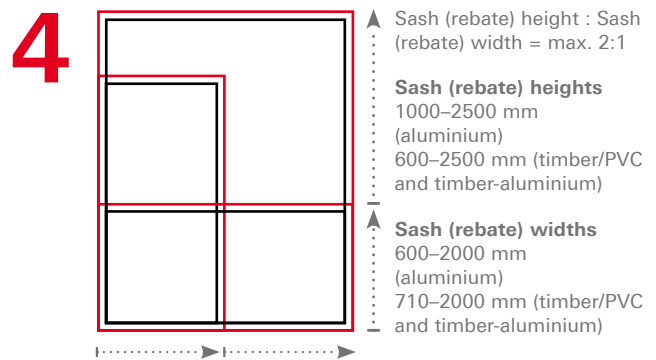

## | Sash size

Roto Patio Inowa demonstrates excellence in every format and covers every application range, from small sliding windows to ceiling-height sliding elements.



# Roto Patio Inowa

---

## Maximum variety

# 5

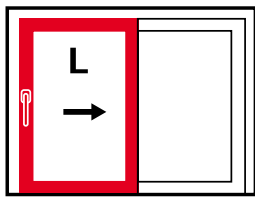

Diagram A, running inward

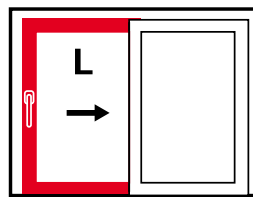

Diagram A, running outward

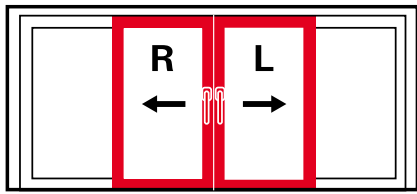

Diagram C, running inward

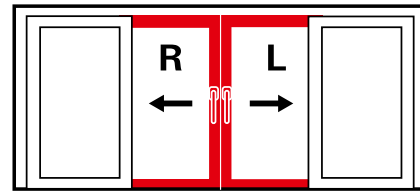

Diagram C, running outward

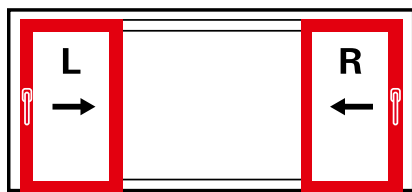

Diagram K, running inward

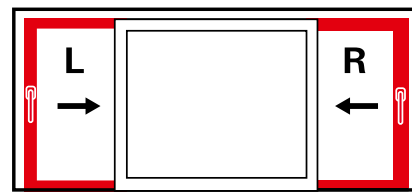

Diagram K, running outward

### | Diagrams

Roto Patio Inowa can be installed running inward and outward and according to diagrams A, C and K. This ensures everything is carried out in accordance with customer requirements.

# Roto Patio Inowa

Efficient  
installation

## Even the installation runs smoothly

Roto Patio Inowa is optimised for quick and easy installation. The assemblies can be installed using just four screws each. Screwing in the centre closer, roller unit and control units into the element immediately undoes the centre fixing. Various sizes can be achieved easily by, for example, simply supplementing a wide leaf door with a roller unit and control unit. This reduces the installation time but not the quality, which remains as high as usual and makes sliding systems with Roto Patio Inowa particularly reliable. This is also reflected in robustly built roller units, which slide smoothly even with high sash weights.

### The Roto advantage: benefits across different systems

The use of components from the proven Roto NT, Roto NX and Roto AL hardware systems effectively decreases the logistics expenditure and storage space requirements.



| Control unit



| Roller unit



| Centre closer





### Simply more Soft skills

For optional Soft functions, only the control unit is supplemented with the corresponding components; the general production process remains unchanged. The components compatible with all profile materials are concealed, thereby preserving the appealing appearance of the system. The unchanged position

of the locking points guarantees compatibility with RC 2. SoftClose and SoftOpen can be combined and installed together. The advantage – the mechanically controlled, braked opening and closing ensures lasting fault-free operation of the sash.

| SoftClose



| SoftOpen





**Roto Frank**  
**Fenster- und Türtechnologie GmbH**

Wilhelm-Frank-Platz 1  
70771 Leinfelden-Echterdingen  
Germany

Phone +49 711 7598 0  
Fax +49 711 7598 253  
info@roto-frank.com

**[www.roto-frank.com](http://www.roto-frank.com)**

**From a single source: Optimum hardware systems to meet all challenges**

- Roto Tilt&Turn** | The Tilt&Turn hardware system for windows and balcony doors
- Roto Sliding** | Hardware systems for large sliding windows and doors
- Roto Door** | Matching hardware technology everything about doors
- Roto Equipment** | Additional technology for windows and doors